



# HALO®

ADVANCED GRAPHITE INSULATION SYSTEM

## Make the switch to today's most advanced rigid insulation system.

Halo® is the insulating system perfectly designed for specific applications.

Now Powered by R-5 Technology!

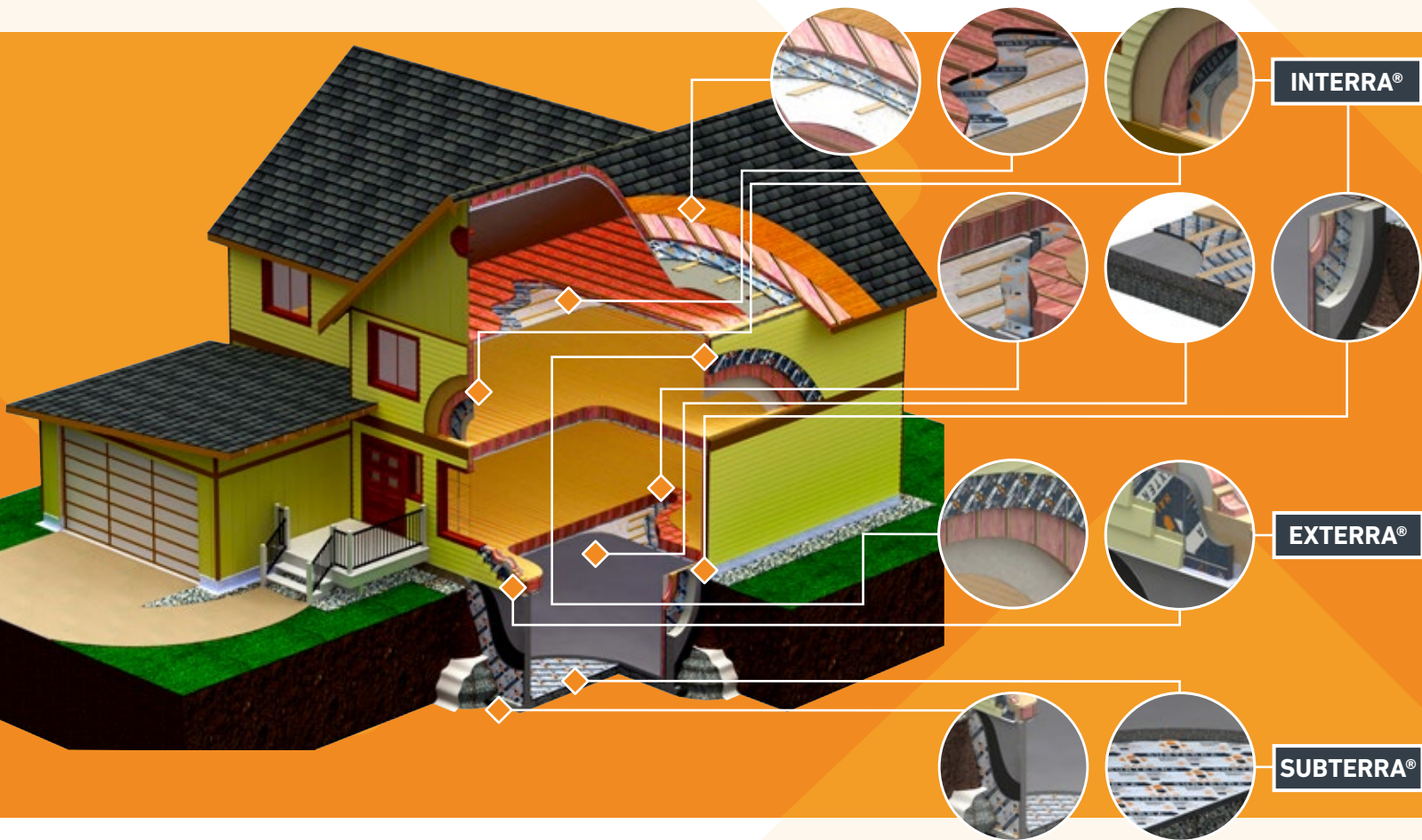

### The Genius of Surround Science

Other insulating solutions offer a cookie-cutter approach. Halo® throws away the mold with a breakthrough insulating system featuring three customized applications:



**HALO INTERRA®**  
Advanced Reflective Interior Rigid Insulation



**HALO EXTERRA®**  
Advanced Breathable Exterior Insulating Sheathing



**HALO SUBTERRA®**  
Advanced Below-Ground Rigid Insulation

[BuildWithHalo.com](http://BuildWithHalo.com)

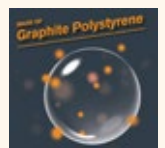



**HALO EXTERRA®**  
Perfectly Designed for Exterior Applications

- Halo® GPS (graphite polystyrene) delivers a long-term R-5 per nominal inch\*
- Breathable — walls stay dry and healthy
- Built-in water-resistive barrier\*\*

\*Thermal performance claim based on thickness of 1 1/16".  
\*\*When joints and fasteners are taped (see the Halo Installation Guide).



Continuous GPS insulation creates a thermal break

Perforated laminate allows vapor to escape the wall assembly

Water kept to the exterior

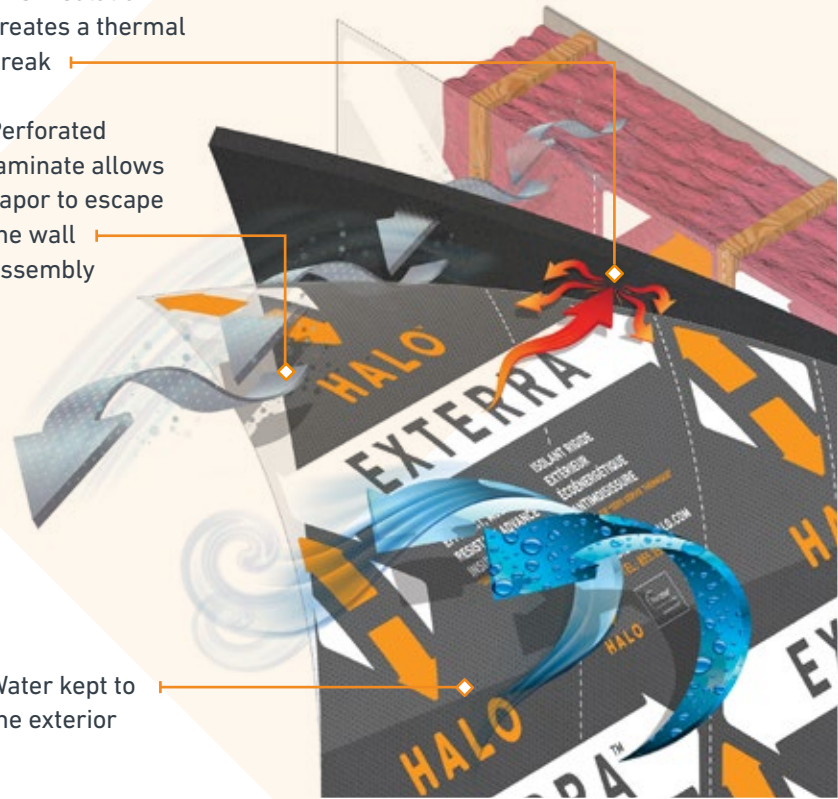

**HALO INTERRA®**  
Perfectly Designed for Interior Applications

- Halo® GPS (graphite polystyrene) delivers a long-term R-5 per nominal inch\*
- Built-in vapor barrier\*\*
- Reflective laminate reflects heat back into the home or building\*\*\*

\*Thermal performance claim based on thickness of 1 1/16".  
\*\*When taped.  
\*\*\*When an appropriate air space is provided.



Continuous GPS insulation creates a thermal break

Reflective laminate partially reflects heat back to the interior

Reflective laminate provides a continuous vapor barrier

Strapping creates an air gap that enables a potential gain in thermal performance

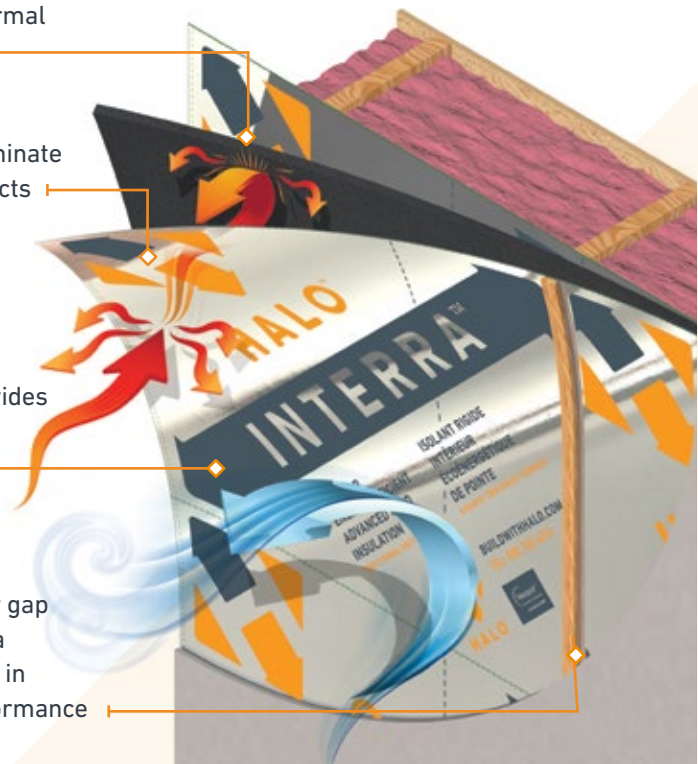



## HALO SUBTERRA®

### Perfectly Designed for Below-Ground Applications

- Halo® GPS (graphite polystyrene) delivers a long-term R-5 per nominal inch\*
- Subterra® is available with a thick polypropylene laminate or with an extra-tough cross-woven laminate (Subterra® Plus)
- Job site tough — able to withstand severe foot and equipment traffic without breaking
- Built-in water-resistive barrier\*\*

\*Thermal performance claim based on thickness of 1 1/16".

\*\*When taped.



Foundation wall

Protects waterproofing

Continuous GPS insulation creates a thermal break

Exterior laminate helps drain water away from the foundation wall.



## Zero thermal drift. Zero compromise.

- Graphite Polystyrene (GPS) provides R-5 per nominal inch\*.
- GPS provides a permanent long-term R-value and won't deteriorate over time like XPS and ISO.
- GPS delivers greater R-values at lower outside temperatures.
- Minimizes the energy loss from thermal bridging.
- Light yet durable — perfect for today's demanding job sites.
- Superior indoor air quality due to Halo®'s clean steam-fused GPS core.
- GPS is 100% recyclable and ozone layer-friendly — no CFCs or HCFCs.

\*Thermal performance claim based on thickness of 1 1/16".



## An innovation in insulation. Right to the very core.

Graphite Polystyrene (GPS) is the new standard in thermal insulation, thanks to millions of graphite infrared absorbers and heat reflectors that reduce thermal conductivity.

## More choice means maximum performance.

Halo® Element	Board Size	Zero Thermal Drift Standard Thicknesses <sup>1</sup>	Compression Guaranteed R-value <sup>2</sup>	Strength <sup>3</sup> psi (KPa)
<b>INTERRA®</b>	4' x 8'	.562", 1.0", 1.5", 2.0"	R-5 per nominal inch (based on thickness of 1 1/16")	10 (70)
<b>EXTERRA®</b>	4' x 8'	.562", .75", 1.0", 1.5", 2.0"	R-5 per nominal inch (based on thickness of 1 1/16")	10 (70)
<b>SUBTERRA®</b> (with polypropylene laminate)	4' x 8'	1.0", 1.5", 2.0"	R-5 per nominal inch (based on thickness of 1 1/16")	16 (110) / 30 (210)
<b>SUBTERRA® PLUS</b> (with cross-woven laminate)	4' x 8'	1.0", 1.5", 2.0"	R-5 per nominal inch (based on thickness of 1 1/16")	16 (110) / 30 (210)

<sup>1</sup>Custom thicknesses and compressive strengths are available upon request. Please contact your local Halo® dealer or representative.  
<sup>2</sup>Typically, XPS and ISO insulation products are not guaranteed to maintain their published R-values over time. Halo® meets or exceeds most XPS-guaranteed R-values (check the guaranteed R-value with your XPS supplier).  
<sup>3</sup>Listed compression values are minimum requirements conforming to ASTM C578 and CAN/ULC S701. Halo® products meet or exceed the requirements of ASTM C578, "Standard Specification for Rigid, Cellular Polystyrene Thermal Insulation", and CAN/ULC S701, "Expanded Polystyrene Insulation Board and Pipe Covering".

## Halo Packaging

Board Thickness	No. of Boards/Bundle
.562"	35
.75"	27
1.0"	20
1.5"	13
2.0"	10

**Installation Instructions:** Refer to the Halo® Installation Guide, available for download at [BuildWithHalo.com](http://BuildWithHalo.com) or from your local Halo® dealer or representative.

### Zero Thermal Drift Guarantee

The use of air as an insulating gas allows Graphite Polystyrene (GPS) to maintain its outstanding R-value performance over time and contributes to sustainable building practices. The air, graphite and polymer matrix in GPS are all stable and no fluorocarbons are used to make, or are contained within GPS. As a result, the R-value provided by GPS will not deteriorate. GPS has zero thermal drift and zero ozone depletion potential. For details, visit [BuildWithHalo.com](http://BuildWithHalo.com).

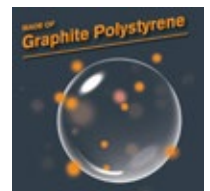

## FOR MORE INFORMATION:

Visit [BuildWithHalo.com](http://BuildWithHalo.com). • Call the Halo® hotline at 855.350.HALO (4256). • Call your local Halo® manufacturer below.

### Perma R Products Inc.

2604 Sunset Dr.  
Grenada, MS  
38901

106 Perma R Rd.  
Johnson City, TN  
37604

800.647.6130

### AMC Foam Technologies Inc.

35 Headingley Rd.  
Headingley, MB  
R4H 0A8  
877.789.7622

### Beaver Plastics Ltd.

11581-272 St.  
Acheson, AB  
T7X 6E9  
888.453.5961

### Progressive Foam Technologies Inc.

6753 Chestnut Ridge Rd.  
Beach City, OH  
44608  
800.860.3626

### Form Solutions

840 Division St.  
Cobourg, ON  
K9A 5V2  
888.706.7709

